

A HELPFUL TOOLS



⚠ Points for attention before installation

- Before installing the new mixer, it is essential that you thoroughly flush through the supply pipes in order to remove any remaining swarf, solder or other impurities. Failure to carry out this simple procedure could cause problems or damage to the working of the mixer.
- If the pictures and statements in the 'Installation Specifications' is unconfirmed with practicality, please take practicality as standard.

B SPECIFICATION

GB This technical product information is exclusively for the installer or trained specialists.

Application

Operation on with unpressurized storage heaters is not possible.

Use for indoor public and common residence.

Operating pressure: 0.1MPa-0.5MPa Use under water pressure, exceeds 0.5MPa a pressure-reducing valve must be fitted.

Sealing test pressure: 1.6 MPa;

Temperature test pressure: 0.3 MPa;

Operating temperature: Cold water temperature 4°C-29°C, Recommended normal use of hot water temperature 55°C-75°C;

Environment temperature: 5°C-45°C;

If static pressure exceeds 0.5 MPa, a pressure-reducing valve must be fitted.

Avoid any pressure differences between hot and cold water supply.



Installation:

Flush piping system prior and after installation of fitting



Function:

Check connection for leaks and check function of fitting bath inlet when the fitting is closed.



Maintenance:

Inspect and clean all components and replace if necessary. Shut off water supply for maintenance work.



When installing the cartridge, ensure that the seals are correctly seated. Tighten the screws evenly and alternately.

C Installation parameters (for reference)

Unit: mm

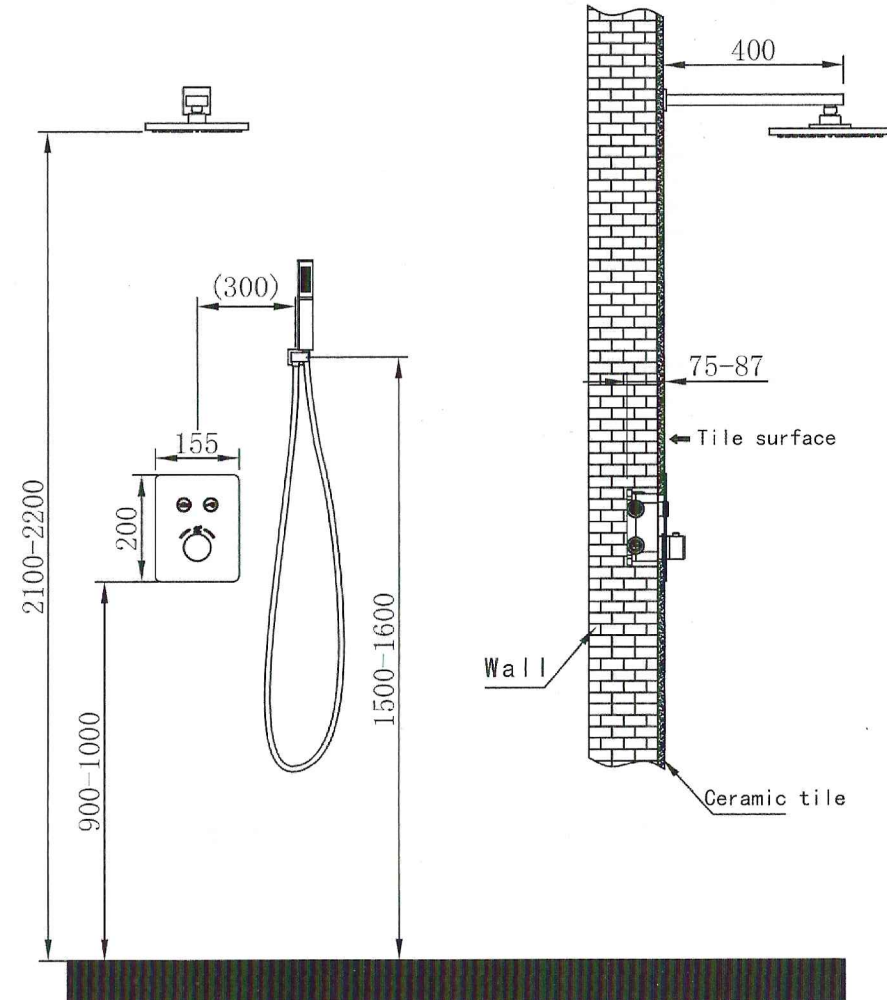

D Hole size of embedded box

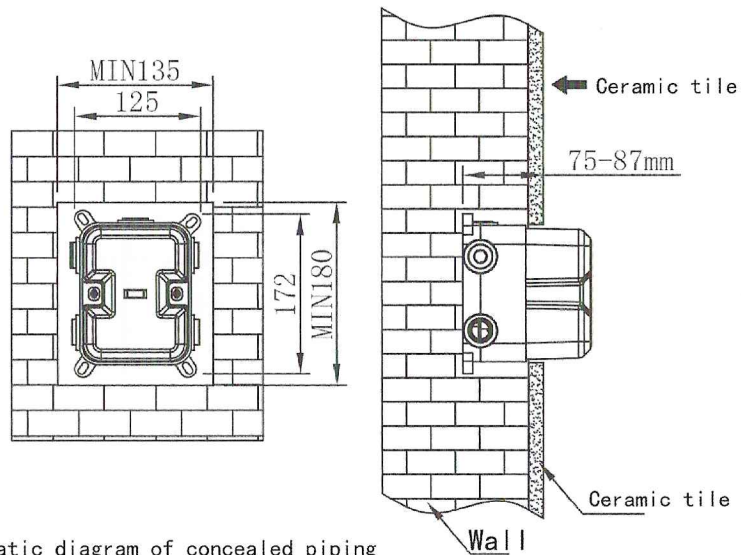

E Schematic diagram of concealed piping

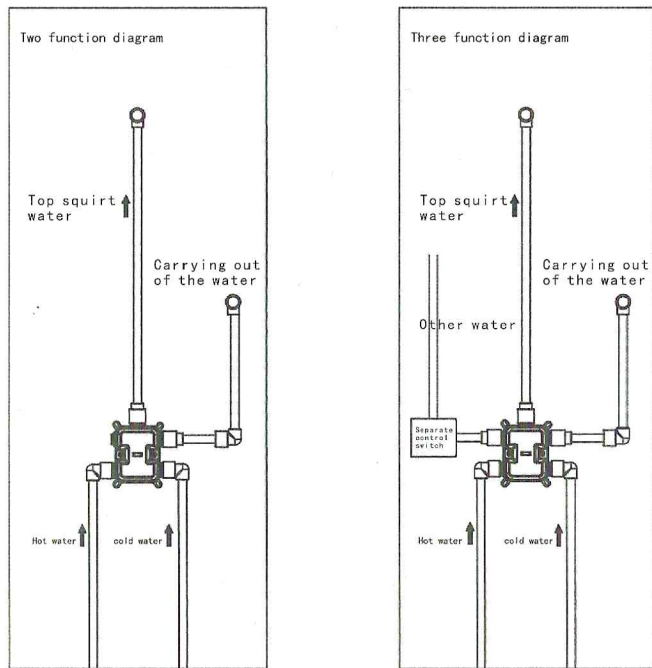

F Handle concealed

一、 After the wall tiles are attached, first remove the protective cover of the embedded box ①, Then remove the the thermostat handwheel ②, cover the panel

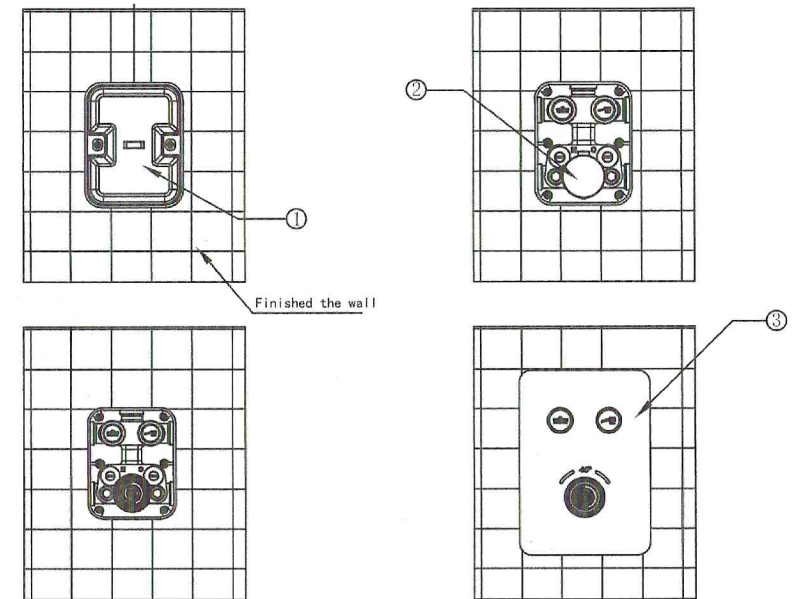

二、 Thermostat handle installation:

1、 check whether the dash line of the thermostatic valve core at 40°C is aligned as shown in the figure after removing the handle(This is the 40°C water temperature marking line detected at the factory);

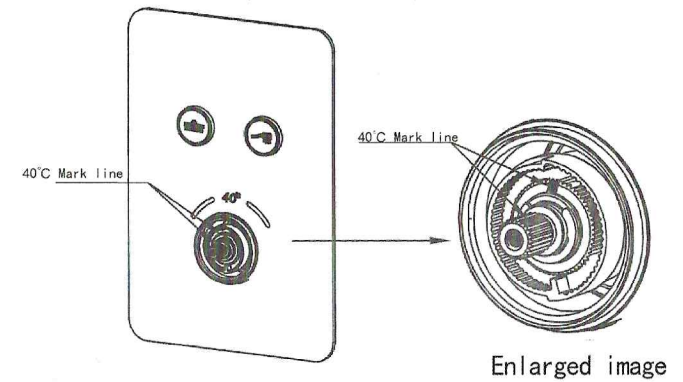

2. Press the thermostat handwheel button⑤; Place the thermostatic handwheel positioning pin⑥as shown in Illustration The direction corresponds to the safety limit of the plastic limit ring⑦ (40°C Strike to be aligned) Insert the thermostatic hand wheel and spool in this direction, Locking screw⑧Then buckle up the plastic decorative cover⑨; The thermostat handwheel is installed;

