

A

INSTALLATION DIMENSION

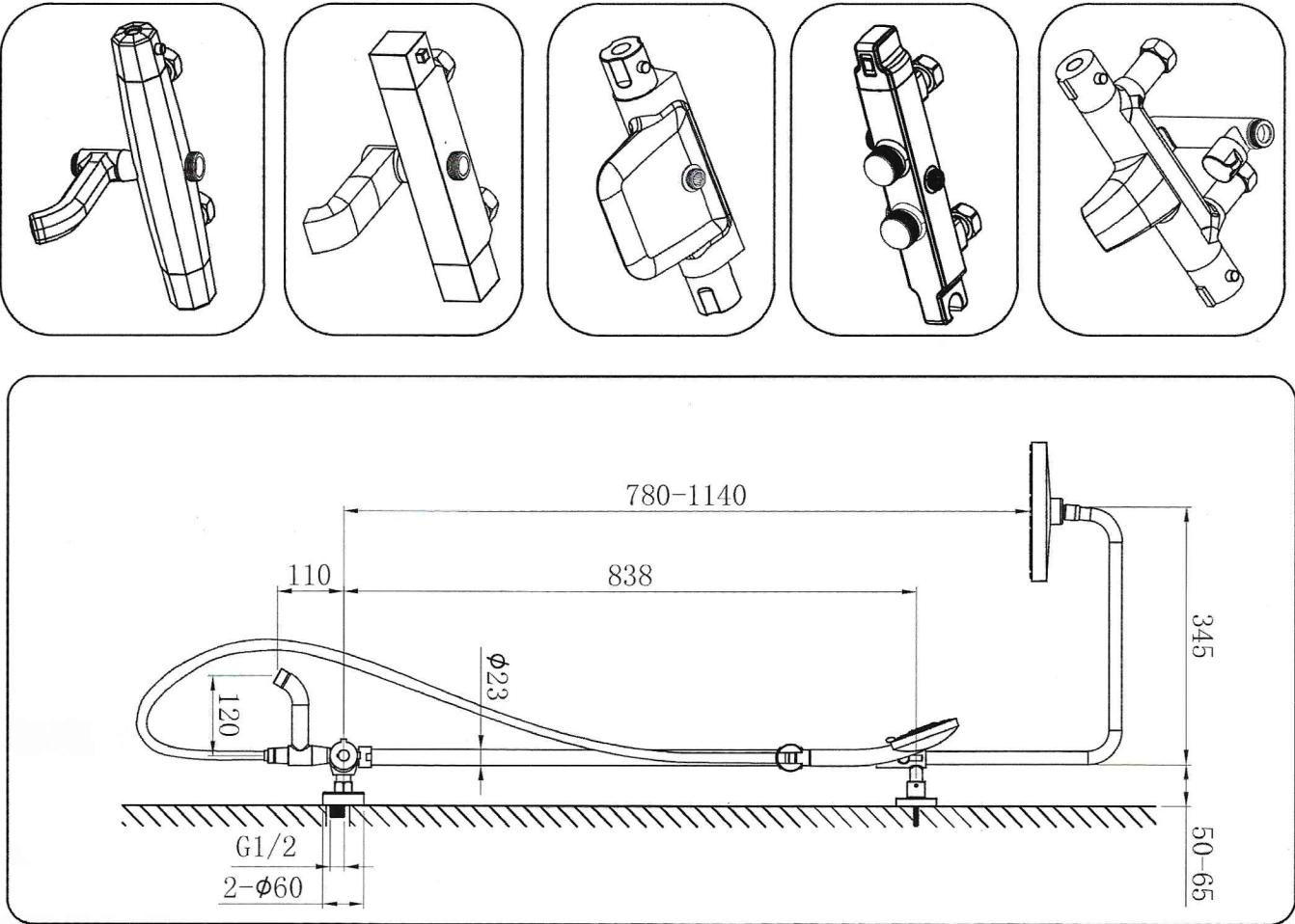

B

HELPFUL TOOLS

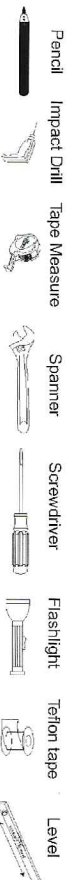

⚠ Points for attention before installation

- Before installing the new mixer, it is essential that you thoroughly flush through the supply pipes in order to remove any remaining sand, silt, solder or other impurities. Failure to carry out this simple procedure could cause problems or damage to the workings of the mixer.
- Work water pressure: 0.5-5kgf/cm² (including cold and hot)
- If the pictures and statements in the "Installation Specifications" is unconfirmed with practicality, please take practicality as standard.

C

INSTALLATION STEP

1

Hot

Cold

150±10

1. Refer to illustrated rough-in dimensions embed hot Supply ailet and cold at right, when facing the wall.

(Note: The hot Supply Outlet and cold Supply Outlet should be in a horizontal position and center distance between them should be 150±15mm.)

2

2 Tighten S-Connectors (1) with Teflon Tape to Water Supplies.

(Note: Don't over-tighten to avoid damage of thread.)

3

3. (a) Cover the Escutcheons (2) onto S-Connectors and against wall.

(b) Place Filter Gasket Assembly (3) into Nut (9) Connect Body (8) to S-Connectors (1) and tighten them.

4

4. The Body completed.

D FAUCET OPERATION

5

5 (a) Refer to figure on the left side of the installation size, draw the installation position of fixed seat with a pencil, and drill hole with impact drill.
 (b) Plug anchor into the hole, fix the base and fixed seat on the wall.

6

6 (a) Press that button on the Hand Shower Holder (13). Then set to Straight Pipe (14).
 (b) Tighten Fastener Seat (16) Clamping Ring (17) and Bend Pipe (18) to Straight Pipe (14).
 (c) Locking the Pipes with the Levers (15).
 (Note: Don't over tighten to avoid damage of threads)

7

7. (a) Put the Pin of the Shower Column into the Fixed seat, Connect Shower Column and Body with Nut (23).
 (b) Fixed the Shower Column to wall parallel with Screws after adjusting it.

8

8. Tighten the Head Shower (24) to the Bend Pipe (20).

9

9. Tighten one side of Shower Hose (25) to Hand Shower (26) and another to Connector (27).
 (Note: Don't over tighten to avoid damage of threads)

10

10. With installation complete, check all connections for leaks.

(A)

1. As shown in Figure (A) for the switch and switch to the handle. The icon state is closed: clockwise 90°: Top spray shower water; clockwise 90 degrees for a faucet outlet; clockwise 90 degrees; and 90 degrees clockwise swinging spout to the left hand shower water.

(B)

2. As shown in figure (B) for the temperature control knob, the state is 38 degrees; adjust the water to the blue logo by pulling the handle; press the button, adjust the hot water to the red side by pulling the handle.

E

SPECIFICATION

GB This technical product information is exclusively for the installer or trained specialists. Please pass these instructions on to the user.

Application:
Operation with unpressurized storage heaters is not possible. Use for indoor public places and common residence.

Specifications

Flow pressure: min. 0,5 bar - recommended 1 - 5 bar

Operating pressure: max. 10 bar

Test pressure: 16 bar

Flow rate at 3 bar flow pressure

for hand shower: ≥ 12 L/min

Hot water inlet temperature: ≥ 12 L/min

Recommended (energy saving): max. 80°C

Environment temperature: 5 °C ~ 45°C

If static pressure exceeds 5 bar, a pressure-reducing valve must be fitted.

Avoid major pressure differences between hot and cold water supply.

Installation:

 Flush piping system prior and after installation of fitting thoroughly (Consider EN 806)!

 Fitting a temperature limiter is possible.

Function:

 Check connections for leaks and check function of fitting.

 Flow is diverted automatically from shower outlet to bath inlet when the fittings are closed.

Maintenance:

 Inspect and clean all components and replace if necessary.

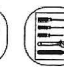
 Shut off water supply for maintenance work.

 When installing the cartridge, ensure that the seals are correctly seated.

 Tighten the screws evenly and alternately.

 Replacement parts see exploded drawing. Care: see Care Instructions.

F

MAINTENANCE

CAUTION: Always turn water OFF before removing existing or disassembling the faucet. Open faucet handle to relieve water pressure and insure that complete water shut-off has been accomplished.

To keep the surface clean and bright, please clean the faucet regularly, please abide by the following procedures:

1. Use rinsing water and soft cloth, clean bilge and bilge membrane on the surface to the best of the abilities.
2. Cleaned the residual with the following cleansers only.
 - Soft liquid cleanser.
 - Colorless glass cleanser, totally soluble powder cleanser without abrasive capability (Mixed by instructions.)
 - No abrasive cleansers waxes
 - Never use cleanser, emery cloth or handkerchief which can rub.
 - Never use cleanser containing abrasive cleansers, ammonia, bleach, acids, waxes, alcohol, solvents or other products not recommended for chrome.
3. After cleaning, use rinsing water to flush out all cleanser immediately and drying with soft cotton cloth.

G

SPECIAL STATEMENT

The products installation instruction is written in accordance with the latest product information, following the sustainable development strategy of the Company, to improve continually the product's specification, performance etc., subject to change without notice. (The Company reserves the right to interpret)